



## OAK

- Strong open grain pattern
- Color variances from light to dark red within panels
- May include mineral deposits, small worm holes, knots and vibrant grain patterns



## MAPLE

- Subtle tight grain pattern
- Smooth uniform appearance
- Color variances from soft white to reddish brown
- May include mineral deposits, small worm holes or knots



## HICKORY

- Typically has a straight grain pattern
- Sapwood is white while the heartwood is pale to reddish brown
- Strong and shock resistant



## CHERRY

- Unique grain patterns
- Color variances from light blonde to dark brown
- Naturally darkens as it ages
- Mineral streaks (pitch pockets) randomly occur

## ALSO AVAILABLE PREMIER OAK VANITIES

All Premier vanities are 31-1/2" high x 21" deep with a 4" high toe kick and feature North American Hardwoods.



VDB24



VDB30



VDB36



VDB48

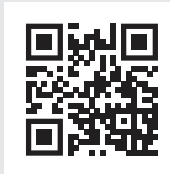

Learn more about Premier Vanities.

# QUALITY ONE

WOODWORK LLC

## PREMIUM READY-TO-FINISH VANITIES



## OAK, MAPLE, HICKORY & CHERRY

Visit our website at:

[www.qualityonewoodwork.com](http://www.qualityonewoodwork.com)



Proudly made in the USA



**OAK**



**MAPLE**



**HICKORY**



**CHERRY**



## AVAILABLE SIZES

All Premium vanities are 34-1/2" high x 21" deep with a 4-1/2" high toe kick and feature North American Hardwoods with all plywood cabinet shell.

### 1 DOOR & 3 DRAWER

Available in left or right drawer stack.

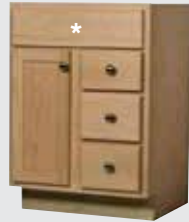

VDB24



VDB30, VDB36

### 2 DOOR & 8 DRAWER



VDB48



VDB60SB (Single Bowl)

### 2 DOOR & 4 DRAWER

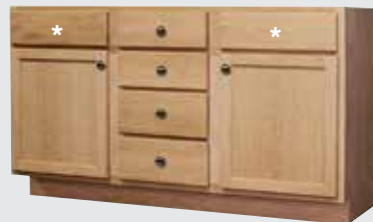

VDB60DB (Double Bowl)

*\*False Front*

### 3 DOOR & 1 DRAWER LINEN CABINET



18" (w) x 78" (h) x 21" (d)

## PREMIUM VANITY FEATURES



Vanity top, cabinet hardware and accessories sold separately.

## PREMIUM VANITY BENEFITS

- Finish your way
- Save money on your project
- Durable long lasting construction
- Premium North American hardwoods